

Glenthorne National Park

- Ityamaitpinna Yarta

Trail Map South



Government
of South Australia

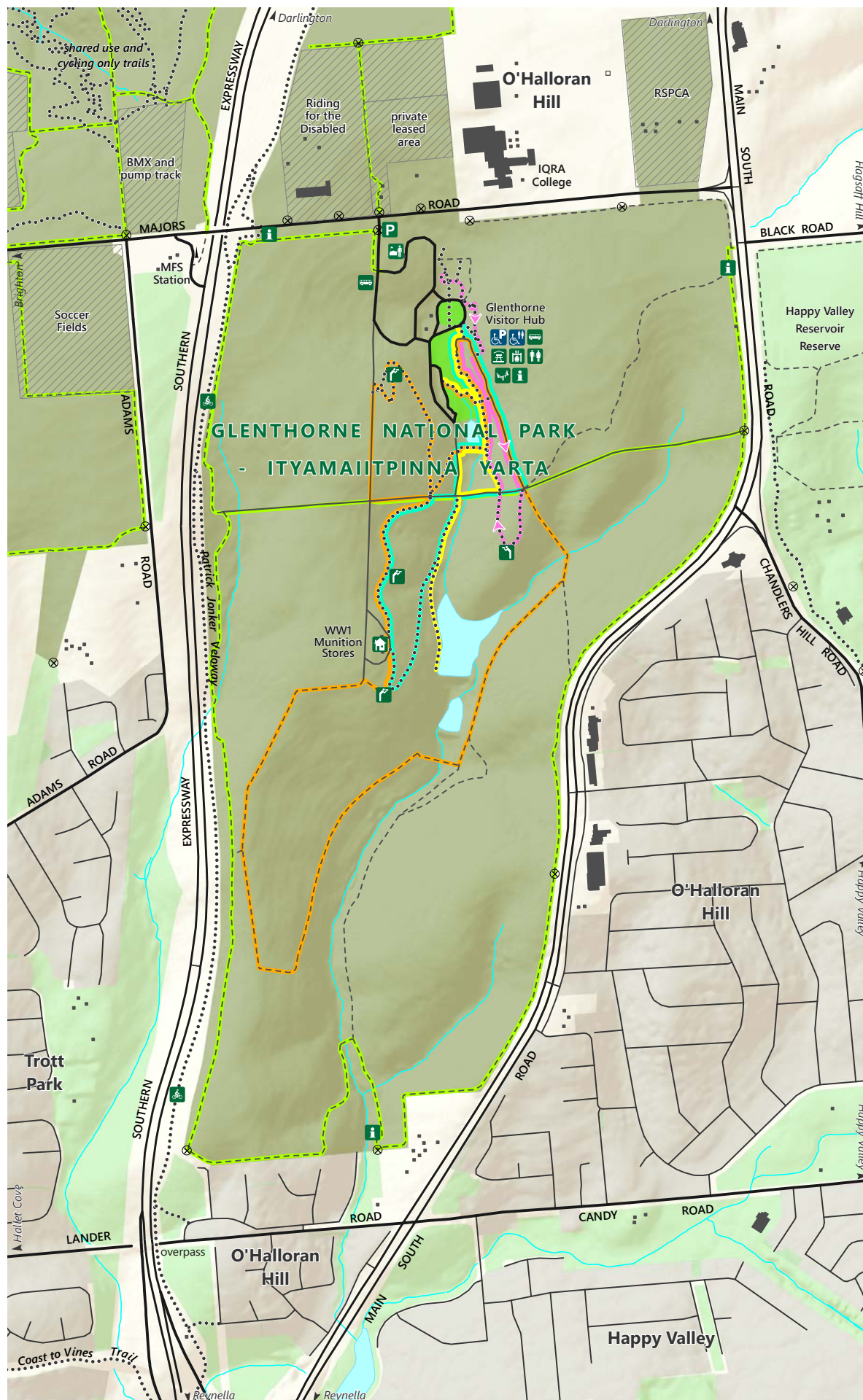

- Sealed road
- Fire access/Management track; Gate
- Walking trail
- Horse riding
- Building

Shared Use Trails

- Footprints from the Past
- Recommended direction of travel
- Grow with me
- Walking with Winaityinaityi
- Warhorse Way

- Accessible parking
- Parking
- Bus parking
- Accessible toilets
- Toilets
- Barbecue
- Information
- Heritage building
- Lookout
- Picnic shelter
- Playground
- Ranger station
- Cycleway

- Glenthorne National Park - Ityamaitpinna Yarta
- Lease areas
- Glenthorne Visitor Hub
- Local reserves
- Built-up area
- Watercourse
- Waterbody



0 250 500
metres

Horse Riding

You can ride along the fire access tracks within the park.

Please note access can be difficult as there is no facility to park a horse float or holding area available.

Generally both cyclists and walkers give way to horses, and cyclists give way to walkers.



DEW does not guarantee that this map is error free. Use of the map is at the user's sole risk and the information contained on the map may be subject to change without notice. Cartography by DEW, Mapland - 2023

Visit parks.sa.gov.au
Get the Avenza Maps app
to use park maps on your phone.

For more information contact:
Department for Environment and Water
E: parks@sa.gov.au
P: 08 8207 7700